

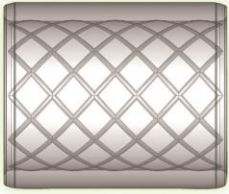
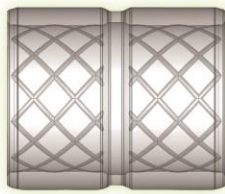
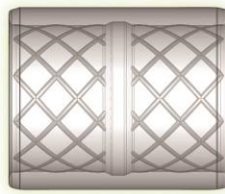

## Boccole EVO

Dalle necessità dei nostri clienti è nata la nuova boccola B.EVO, un prodotto innovativo in grado di soddisfare i bisogni del cliente più esigente. Questa speciale boccola è stata studiata per avere una maggiore durata e un minor coefficiente di attrito. La speciale combinazione di più trattamenti specifici la rendono straordinariamente resistente all'usura e al grippaggio. Inoltre le speciali cave interne permettono una distribuzione eccellente del grasso che garantisce una lubrificazione continua ed omogenea.

È vietata la copia e la riproduzione dei contenuti e immagini in qualsiasi forma. È vietata la redistribuzione e la pubblicazione dei contenuti e immagini non autorizzata espressamente. Copyright © 04/2019 - Sibo - All rights reserved

**Boccole Spider**

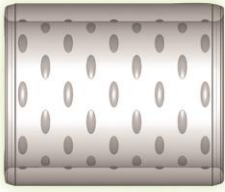
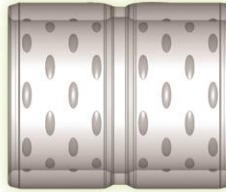
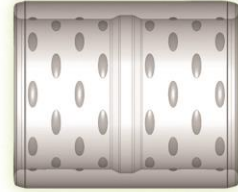
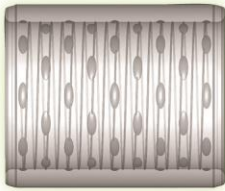
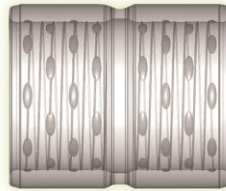
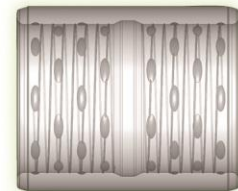
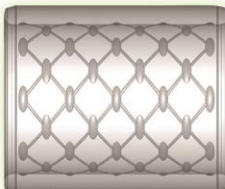
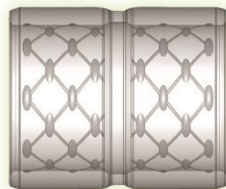
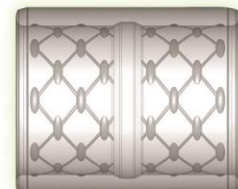
**SPA** L ZIG

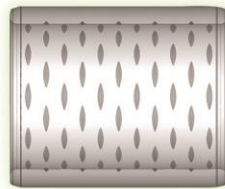
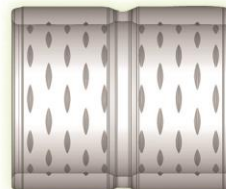
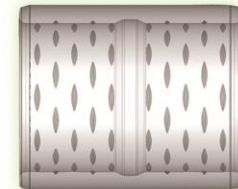
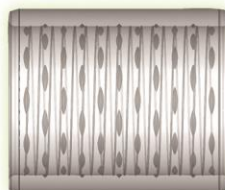
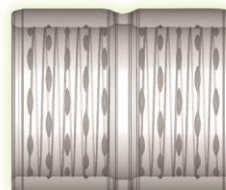
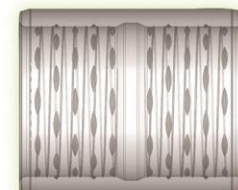
**SPB** GF ZIG

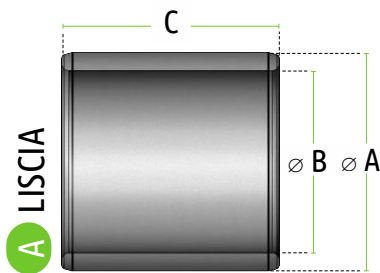
**SPH** GI ZIG

**Boccole Bubble**

**BBA** L+CAVE BUBBLE

**BBB** GF+CAVE BUBBLE

**BBH** GI+CAVE BUBBLE

**BB1A** LR SP NU+CAVE BUBBLE

**BB1B** GFR SP NU+CAVE BUBBLE

**BB1H** GIR SP NU+CAVE BUBBLE

**BB2A** L ZIG+CAVE BUBBLE

**BB2B** GF ZIG+CAVE BUBBLE

**BB2H** GI ZIG+CAVE BUBBLE

**Boccole Diamond**

**BDA** L+CAVE DIAMOND

**BDB** GF+CAVE DIAMOND

**BDH** GI+CAVE DIAMOND

**BD1A** LR SP.NU+CAVE DIAMOND

**BD1B** GFR SP.NU+CAVE DIAMOND

**BD1H** GIR SP.NU+CAVE DIAMOND



∅ A diametro esterno/external diameter

∅ B diametro interno/internal diameter

C lunghezza/length

### Gamma dimensionale

A	B	C	A	B	C	A	B	C	A	B	C
		20			30			30			35
		25			35			35			40
		30			40			40			45
		35			45			45			50
		40			50			50			55
		45			55			55			60
		50			60			60	80	70	60
		55	45	35	65	60	50	65			65
		60			70			70			70
		65			75			75			80
		30			80			80			90
		35			85			85			100
		40			90			90			35
		45			95			95			40
		50			100			100			45
		55			30			35			50
		60			35			40			55
		65			40			45	85	75	60
		70			45			50			65
		75			50			55			70
		80			55	65	55	60			80
		85			60			65			90
		90	50	40	65			70			100
		95			70			75			40
		100			75			80			45
		30			80			90			50
		35			85			35			55
		40			90			40	90	80	65
		45			95			45			60
		50			100			50			70
		60			30			55			80
		65			35	70	60	60			90
		70			40			65			95
		80			45			70			100
		30			50			80			40
		35			55			90			45
		40			60			100			50
		45			65			35			55
		50	55	45	70			40	95	85	60
		55			75			45			70
		60			80			50			80
		65			85			55			90
		70			90	75	65	60			100
		75			95			65			40
		80			100			70			45
		85			>>			80			50
		90			>>			90			55
		95			>>			100	100	90	60
		100			>>			100			70
		>>			>>			100			80
		>>			>>			100			90
		>>			>>			100			100

### Tolleranze standard

∅ mm Esterno Outside	Toll. u6 (µm)	∅ mm Interno Outside	Toll. C8 (µm)
> 24	+61	> 18	+143
≤ 30	+48	≤ 30	+110
> 30	+76	> 30	+159
≤ 40	+60	≤ 40	+120
> 40	+86	> 40	+169
≤ 50	+70	≤ 50	+130
> 50	+106	> 50	+186
≤ 65	+87	≤ 65	+140
> 65	+121	> 65	+196
≤ 80	+102	≤ 80	+150
> 80	+146	> 80	+224
≤ 100	+124	≤ 100	+170
> 100	+166	> 100	+234
≤ 120	+144	≤ 120	+180
> 120	+195	> 120	+263
≤ 140	+170	≤ 140	+200
> 140	+215	> 140	+273
≤ 160	+190	≤ 160	+210
> 160	+235	> 160	+293
≤ 180	+210	≤ 180	+230
> 180	+265	> 180	+312
≤ 200	+236	≤ 200	+240
> 200	+287	> 200	+332
≤ 225	+258	≤ 225	+260