



EVO™ BUSHES

The needs of our customers have resulted in the new B.EVO bushing, an innovative product that will meet the needs of the most demanding customer.

This special bushing is designed to have a longer life and a lower friction coefficient. The special combination of more specific treatments make it exceptionally resistant to wear and seizure. In addition, the special internal grooves allow excellent distribution of the lubrication that ensures continuous and homogeneous lubrication.

*****This product is not delivered to Germany, Austria and Switzerland*****

Copying and reproduction of contents and images in any form is prohibited. Redistribution and publication of content and images that are not expressly authorized is prohibited.

Copyright © 04/2019 - Sibo - All rights reserved



Spider Bushes

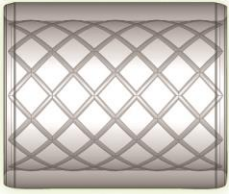

SPA L ZIG

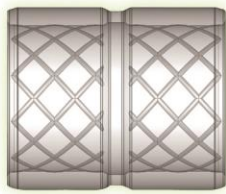

SPB GF ZIG

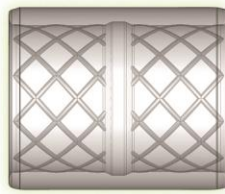

SPH GI ZIG

Bubble Bushes

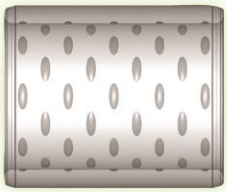

BBA L+CAVE BUBBLE

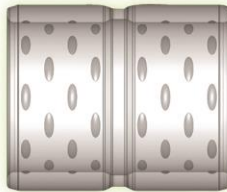

BBB GF+CAVE BUBBLE

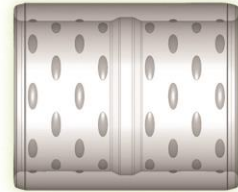

BBH GI+CAVE BUBBLE

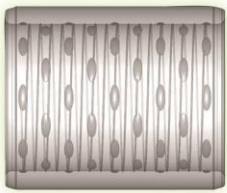

BB1A LR SP NU+CAVE BUBBLE

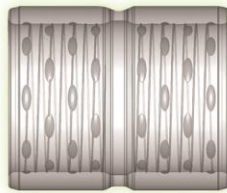

BB1B GFR SP NU+CAVE BUBBLE

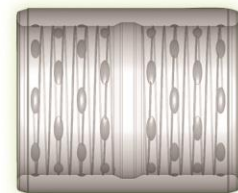

BB1H GIR SP NU+CAVE BUBBLE

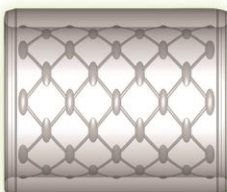

BB2A L ZIG+CAVE BUBBLE

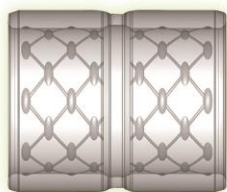

BB2B GF ZIG+CAVE BUBBLE

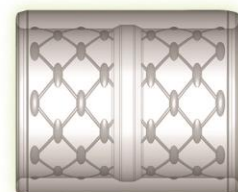

BB2H GI ZIG+CAVE BUBBLE

Diamond Bushes

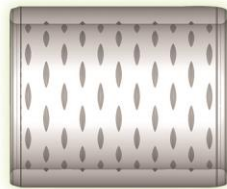

BDA L+CAVE DIAMOND

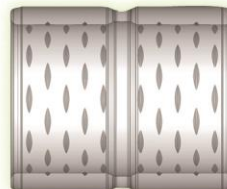

BDB GF+CAVE DIAMOND

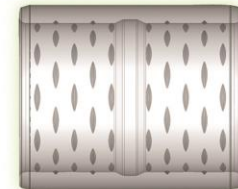

BDH GI+CAVE DIAMOND

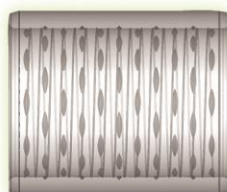

BD1A LR SP.NU+CAVE DIAMOND

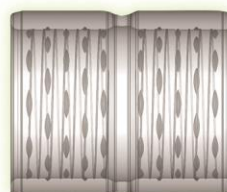

BD1B GFR SP.NU+CAVE DIAMOND

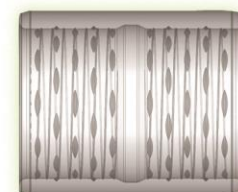

BD1H GIR SP.NU+CAVE DIAMOND

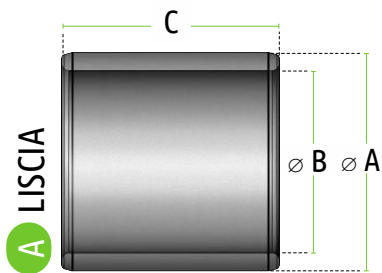

Ø A diametro esterno/external diameter

Ø B diametro interno/internal diameter

C lunghezza/length

Production Range

A	B	C	A	B	C	A	B	C	A	B	C
		20			30			30			35
		25			35			35			40
		30			40			40			45
		35			45			45			50
		40			50			50			55
		45			55			55	80	70	60
		50			60			60			65
		55	45	35	65	60	50	65			70
		60			70			70			75
		65			75			75			80
		30			80			80			90
		35			85			85			100
		40			90			90			35
		45			95			95			40
		50			100			100			45
		55			30			35			50
		60			35			40			55
		65			40			45	85	75	60
		70			45			50			65
		75			50			55			70
		80			55	65	55	60			75
		85			60			65			80
		90	50	40	65			70			85
		95			70			75			90
		100			75			80			95
		30			80			85			100
		35			85			90			50
		40			90			95			55
		45			95			100	90	80	65
		50			100			50			70
		60			30			55			75
		65			35	70	60	60			80
		70			40			65			85
		75			45			70			90
		80			45			75			95
		85			50			80			100
		30			55			85			40
		35			55			90			45
		40			60			95			50
		45			65			100			55
		50	55	45	65			35	95	85	60
		55			70			40			65
		60			75			45			70
		65			80			50			75
		70			85			55			80
		75			90	75	65	60			85
		80			95			65			90
		85			100			70			95
		90			>>			75			100
		95			>>			80			100
		100			>>			85			100
		>>			>>			90	100	90	60
		>>			>>			95			65
		>>			>>			100			70
		>>			>>			100			75
		>>			>>			100			80
		>>			>>			100			85
		>>			>>			100			90
		>>			>>			100			95
		>>			>>			100			100

Standard tollerances

Ø mm Esterno Outside	Toll. u6 (µm)	Ø mm Interno Outside	Toll. C8 (µm)
> 24	+61	> 18	+143
≤ 30	+48	≤ 30	+110
> 30	+76	> 30	+159
≤ 40	+60	≤ 40	+120
> 40	+86	> 40	+169
≤ 50	+70	≤ 50	+130
> 50	+106	> 50	+186
≤ 65	+87	≤ 65	+140
> 65	+121	> 65	+196
≤ 80	+102	≤ 80	+150
> 80	+146	> 80	+224
≤ 100	+124	≤ 100	+170
> 100	+166	> 100	+234
≤ 120	+144	≤ 120	+180
> 120	+195	> 120	+263
≤ 140	+170	≤ 140	+200
> 140	+215	> 140	+273
≤ 160	+190	≤ 160	+210
> 160	+235	> 160	+293
≤ 180	+210	≤ 180	+230
> 180	+265	> 180	+312
≤ 200	+236	≤ 200	+240
> 200	+287	> 200	+332
≤ 225	+258	≤ 225	+260